

CCAD Frontage
Sheet 5

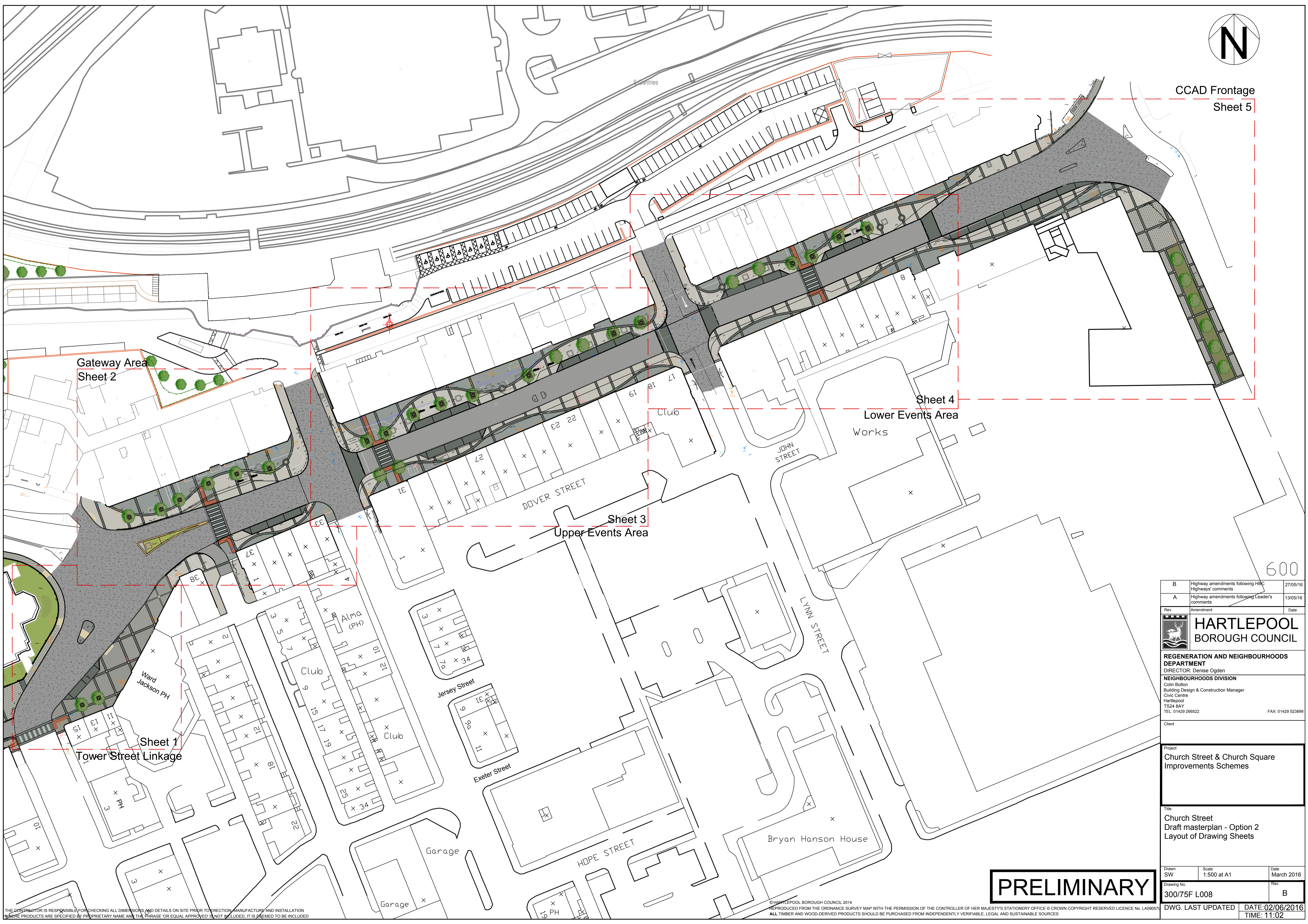

Gateway Area
Sheet 2

Sheet 4
Lower Events Area
Works

Sheet 3
Upper Events Area

Sheet 1
Tower Street Linkage

600

Rev	Amendment	Date
B	Highway amendments following HBC Highways' comments	27/05/16
A	Highway amendments following Leader's comments	13/05/16



HARTLEPOOL BOROUGH COUNCIL
REGENERATION AND NEIGHBOURHOODS DEPARTMENT
 DIRECTOR: Denise Ogden
NEIGHBOURHOODS DIVISION
 Colin Bolton
 Building Design & Construction Manager
 Civic Centre
 Hartlepool
 TS24 8AY
 TEL: 01429 286522 FAX: 01429 523899

Client
 Project
Church Street & Church Square Improvements Schemes

Title
Church Street Draft masterplan - Option 2 Layout of Drawing Sheets

Drawn	Scale	Date
SW	1:500 at A1	March 2016

Drawing No.	Rev.
300/75F L008	B

PRELIMINARY

DWG. LAST UPDATED DATE: 02/06/2016 TIME: 11:02

THE CONTRACTOR IS RESPONSIBLE FOR CHECKING ALL DIMENSIONS AND DETAILS ON SITE PRIOR TO ERECTION, MANUFACTURE AND INSTALLATION. WHERE PRODUCTS ARE SPECIFIED BY PROPRIETARY NAME AND THE PHRASE 'OR EQUAL APPROVED' IS NOT INCLUDED, IT IS DEEMED TO BE INCLUDED.

© HARTLEPOOL BOROUGH COUNCIL 2014. REPRODUCED FROM THE ORDNANCE SURVEY MAP WITH THE PERMISSION OF THE CONTROLLER OF HER MAJESTY'S STATIONERY OFFICE © CROWN COPYRIGHT RESERVED LICENCE No. LA090571. ALL TIMBER AND WOOD-DERIVED PRODUCTS SHOULD BE PURCHASED FROM INDEPENDENTLY VERIFIABLE, LEGAL AND SUSTAINABLE SOURCES.