

Traffic Regulation Order, Temporary Closure and Diversion of Public Footpath No.31, Hartlepool, between Brus Tunnel and Old Cemetery Road

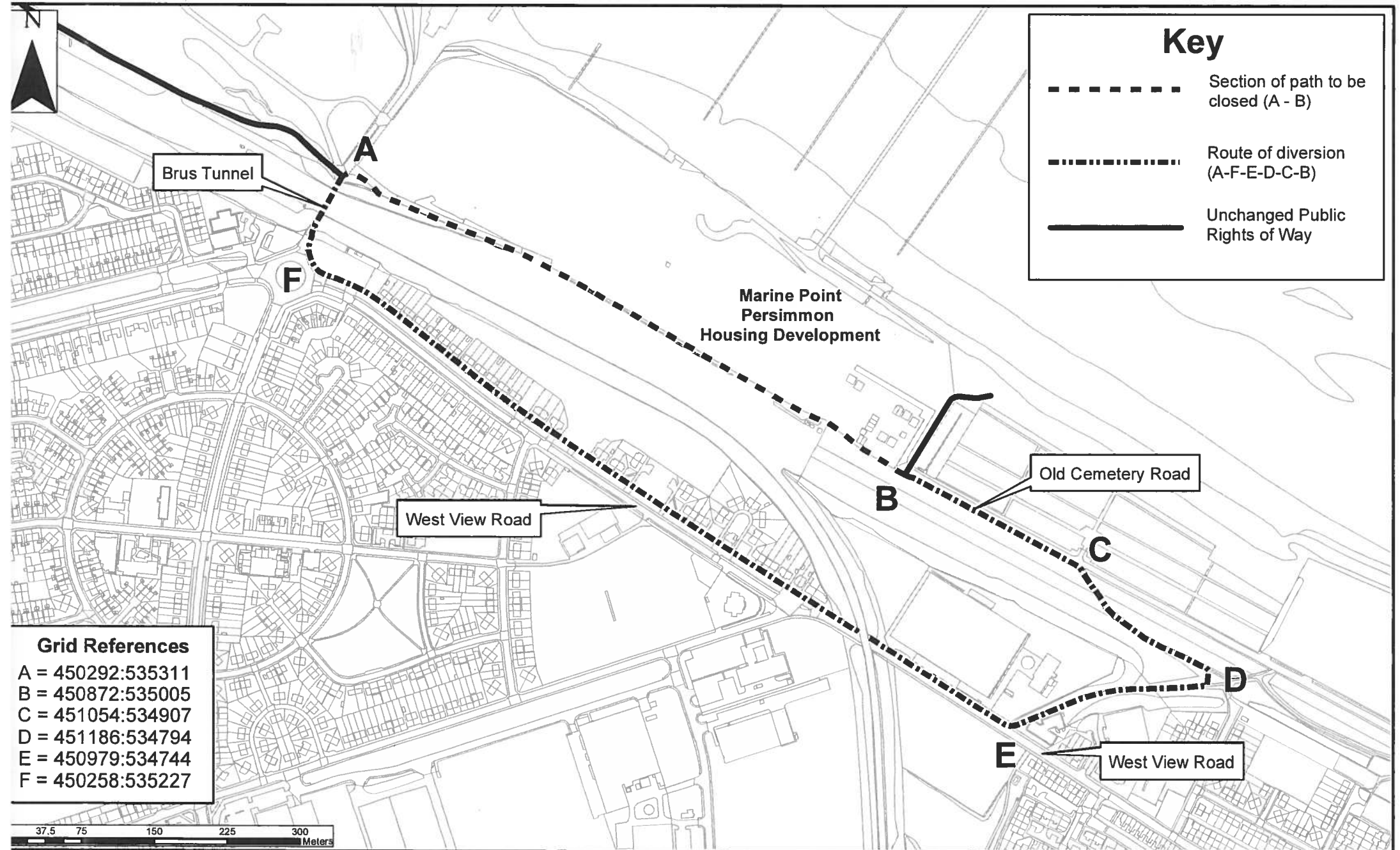

This map is based upon Ordnance Survey material with the permission of Ordnance Survey on behalf of the Controller of Her Majesty's Stationary Office Crown Copyright. Unauthorised reproduction infringes Crown copyright and may lead to prosecution or civil proceedings. (100023390) (2017)

Sub Title: Temporary Closure Hartlepool 31
 Scale: 1:5,000
 Date: 20th June 2017
 Drawn By: Heritage and Countryside

Hartlepool Borough Council
 Heritage and Countryside
 Level 1, Civic Centre
 Victoria Road
 Hartlepool, TS24 8AY Tel: 01429523524