



HARTLEPOOL BOROUGH COUNCIL

OFFICER DECISION RECORD

Department: Regeneration & Neighbourhoods Directorate

Division: Estates & Regeneration Section

Date of Decision / Issue of Licence: 27/07/2018

Officer Making Decision: Tim Wynn (Strategic Asset Manager)

Subject / Description & Reason for Decision: Property – Land at Old Cemetery Road, Hartlepool
It is proposed that The Council grants a right of way to Network Rail to allow them access across an area of Council owned public open space for the purpose of carrying out maintenance to the tracks in the vicinity. Network Rail will be responsible for laying a compacted aggregate surface across the land. The Council are proposing to charge Network Rail a one off fee of £1,000 plus surveyors fees of £500 and legal fees of £750

Type of Decision: Non Key

Nature of Delegation Being Exercised: Committee Delegated Authority
The Director of Regeneration and Neighbourhoods has delegated powers for a variety of transactions within a prescribed threshold which is currently £30,000 in capital value and £12,000 in rental value. The powers are to approve land and property disposals, leases, lettings, licences, wayleaves, easements, undertaking and concluding rent reviews, lease renewals and the release and amendments of restrictions, covenants and other land and property matters within the prescribed thresholds as approved by the Council.
Delegated Powers Authority was approved at Finance & Policy Committee on 18 July 2012

Alternative Options Considered & Rejected: To not allow formal access, making necessary maintenance to the track more difficult

ODR No.: TO BE COMPLETED BY DST

Any Declared Register of Interest No

OFFICER WITH THE DELEGATION

NAME: Tim Wynn 

POSITION: Strategic Asset Manager

In consultation with Denise Ogden, Director of Regeneration and Neighbourhoods



Marine Point

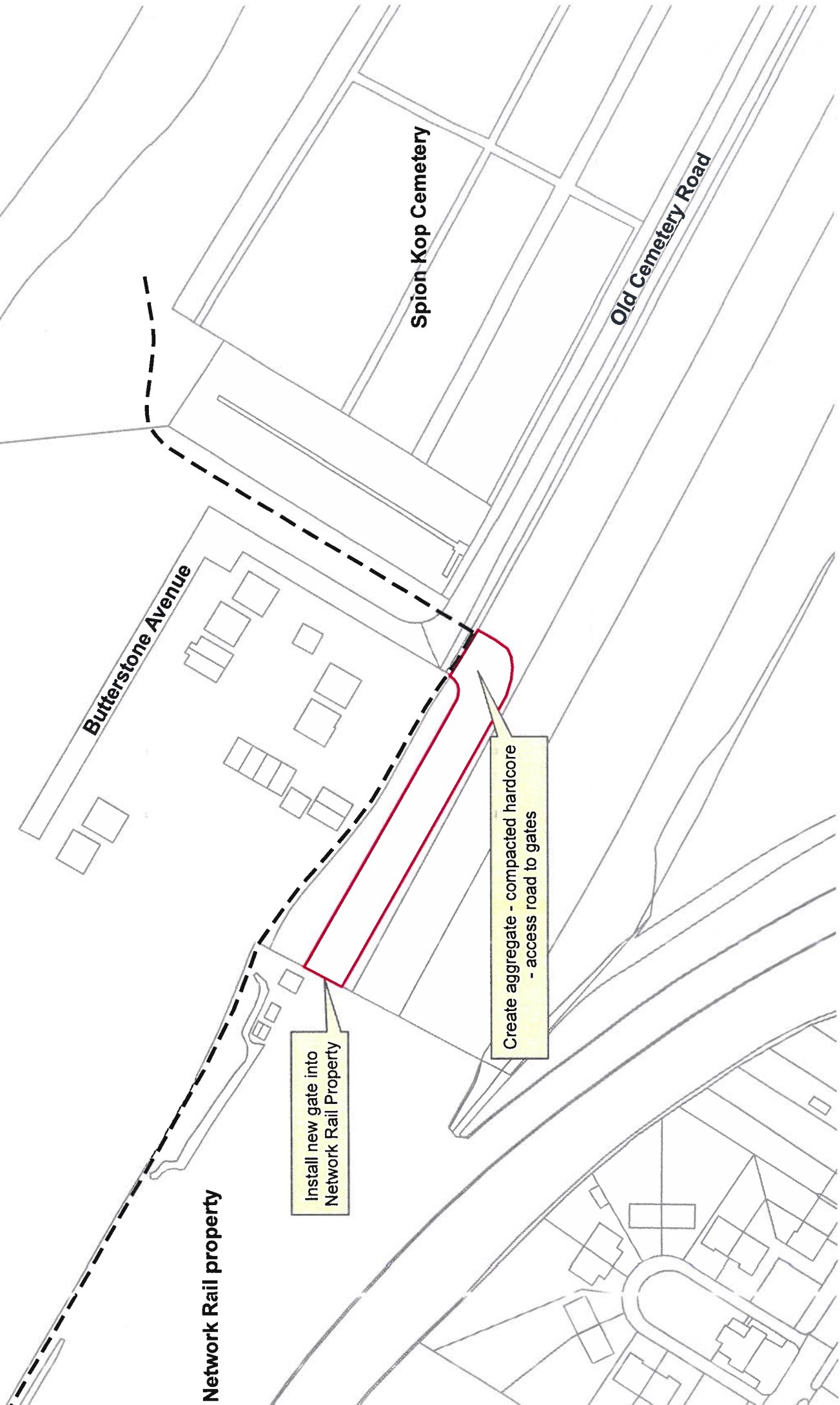

Spion Kop Cemetery

Old Cemetery Road

Butterstone Avenue

Network Rail property

Install new gate into
Network Rail Property

Create aggregate - compacted hardcore
- access road to gates

