



HARTLEPOOL BOROUGH COUNCIL

OFFICER DECISION RECORD

Department: Regeneration and Neighbourhoods

Division: Asset Management

Date of Decision /
Issue of Licence: 22nd August 2018

Officer Making
Decision: Tim Wynn (Strategic asset Manager)

Subject / Description
& Reason for
Decision: Property – Grant of Wayleave
Grant of a wayleave to Northern Power grid to allow the erection of a new pole and stays (and the removal of an existing power line) on land at Hart.
The wayleave is required to alter the configuration of power lines to allow development of the adjoining residential site.
In line with Northern Powergrid's standard wayleave payments, a payment of £17.75 per annum will be made to the Council.

Type of Decision: Non Key

Nature of Delegation
Being Exercised: Committee Delegated Authority
The Director of Regeneration and Neighbourhoods has delegated powers for a variety of transactions within a prescribed threshold which is currently £30,000 in capital value and £12,000 in rental value. The powers are to approve land and property disposals, leases, lettings, licences, wayleaves, easements, undertaking and concluding rent reviews, lease renewals and the release and amendments of restrictions, covenants and other land and property matters within the prescribed thresholds as approved by the Council.

Delegated Powers Authority was approved at Finance & Policy Committee on 18 July 2012

ODR No.: TO BE COMPLETED BY DST

Alternative Options Considered & Rejected: None

Any Declared Register of Interest: No

OFFICER WITH THE DELEGATION

NAME: Denise Ogden

 22/8/18

POSITION: Director of Regeneration and Neighbourhoods

In consultation with: Tim Wynn
Strategic Asset Manager



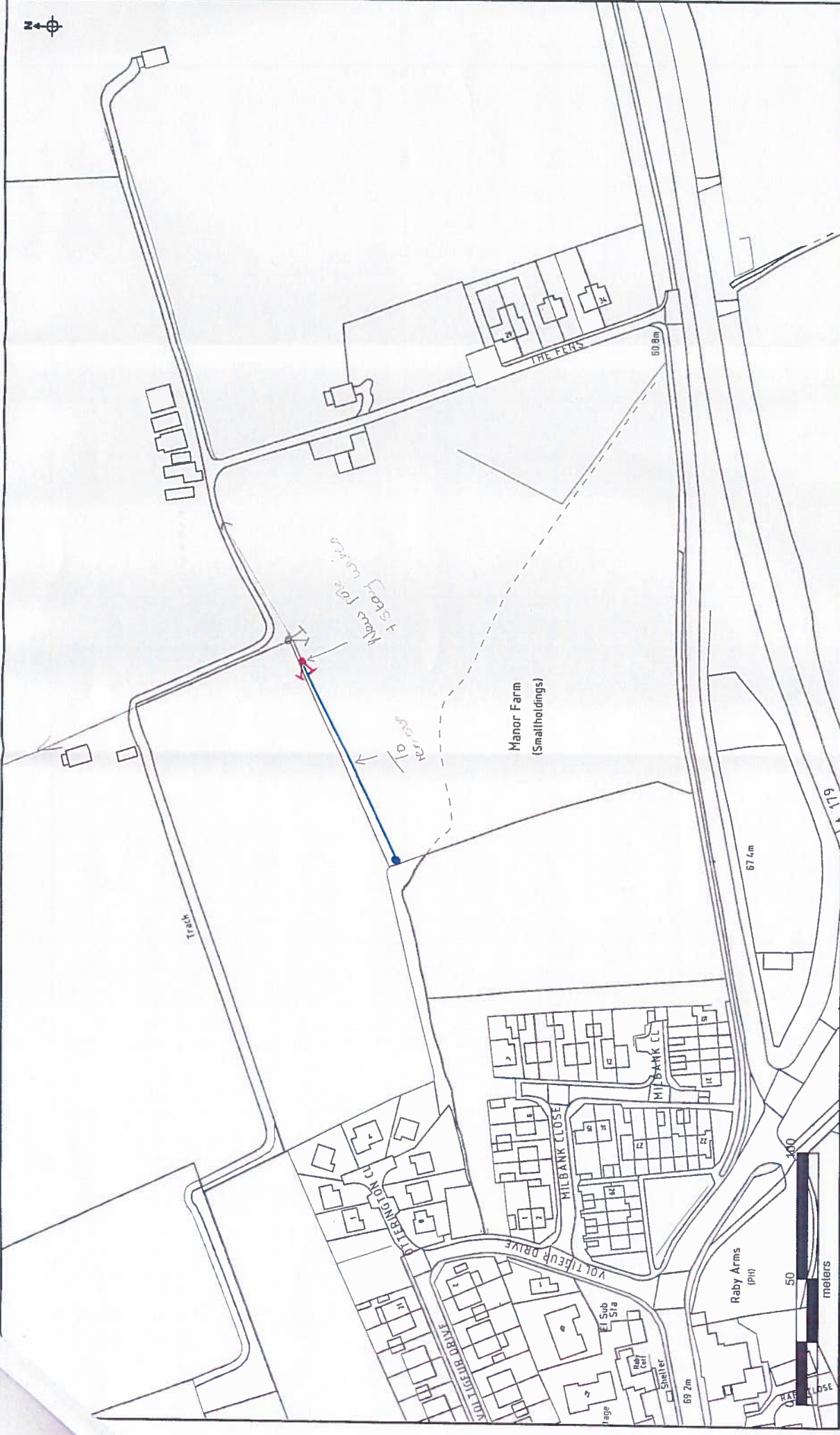

OS Grid Reference: NZ4743035083
 Printed By: caroline.gray
 Title:

Date Printed: 04-May-2018
 Scale: 1:1387

Call Centre Phone Numbers: If the area is located in North East call 0900 0638377, Yorkshire or North Lincoln call 0900 375675
 Northern Powergrid Holdings Company
 The information on this plan is as accurate as possible. It may have changed since the plan was produced. Therefore the position of our equipment and lines are not guaranteed. Electrical cables not owned by Northern Powergrid Holdings Company may be laid in this area and may not be shown on this plan. Where private cables are shown, the information should not be regarded as accurate and should be used for guidance purposes only. In all cases, accurate information should be obtained from the owner of such cables prior to the commencement of work on site.
 Reference should be made to HSE Guidance, HSG67 'Avoiding Danger from Underground Services' and G59 'Avoidance of Danger from Overhead Power Lines'.
 Drawn from a plan issued under the Ordnance Survey name by Northern Powergrid Holdings Company by permission of Ordnance Survey on behalf of the Controller of Her Majesty's Stationery Office. Crown Copyright © Northern Powergrid Holdings Company Ltd 2018. All Rights Reserved.
 Version 1.0 13th June 2017

