



HARTLEPOOL BOROUGH COUNCIL

OFFICER DECISION RECORD

Department: Regeneration & Neighbourhoods Directorate

Division: Strategic Asset Management Section

Date of Decision /
Issue of Licence: 17/01/20

Officer Making
Decision: Tim Wynn (Strategic Asset Manager)

Subject / Description
& Reason for
Decision: Permission to occupy Land at Dalton Piercy

It is proposed to grant a licence to occupy the premises shown edged red in the attached plan (The occupant will also have permission to cross the land shaded green) for use as an agricultural garden. This licence is to the son of the recently deceased former occupant. The term is for an ongoing period from 11th December 2019 until it is determined. A licence fee has been agreed and the Licencee is to be responsible for all outgoings in relation to the site. There is a break clause that can be invoked by either party at any time by giving 1 month notice.

Type of Decision: Non Key

Nature of Delegation
Being Exercised: Committee Delegated Authority

The Director of Regeneration and Neighbourhoods and the Chief Solicitor have delegated powers for a variety of transactions within £100,000 in capital value and £50,000 in rental value (annual figure). The powers are to approve land and property disposals and acquisitions, leases, lettings, licences, wayleaves, easements, undertaking and concluding rent reviews, lease renewals and the release and amendments of restrictions, covenants and other land and property matters.

Delegated Powers Authorisation was given on 24 May 2019 by the Director of Regeneration and Neighbourhoods and the Chief Solicitor to the Strategic Asset Manager.

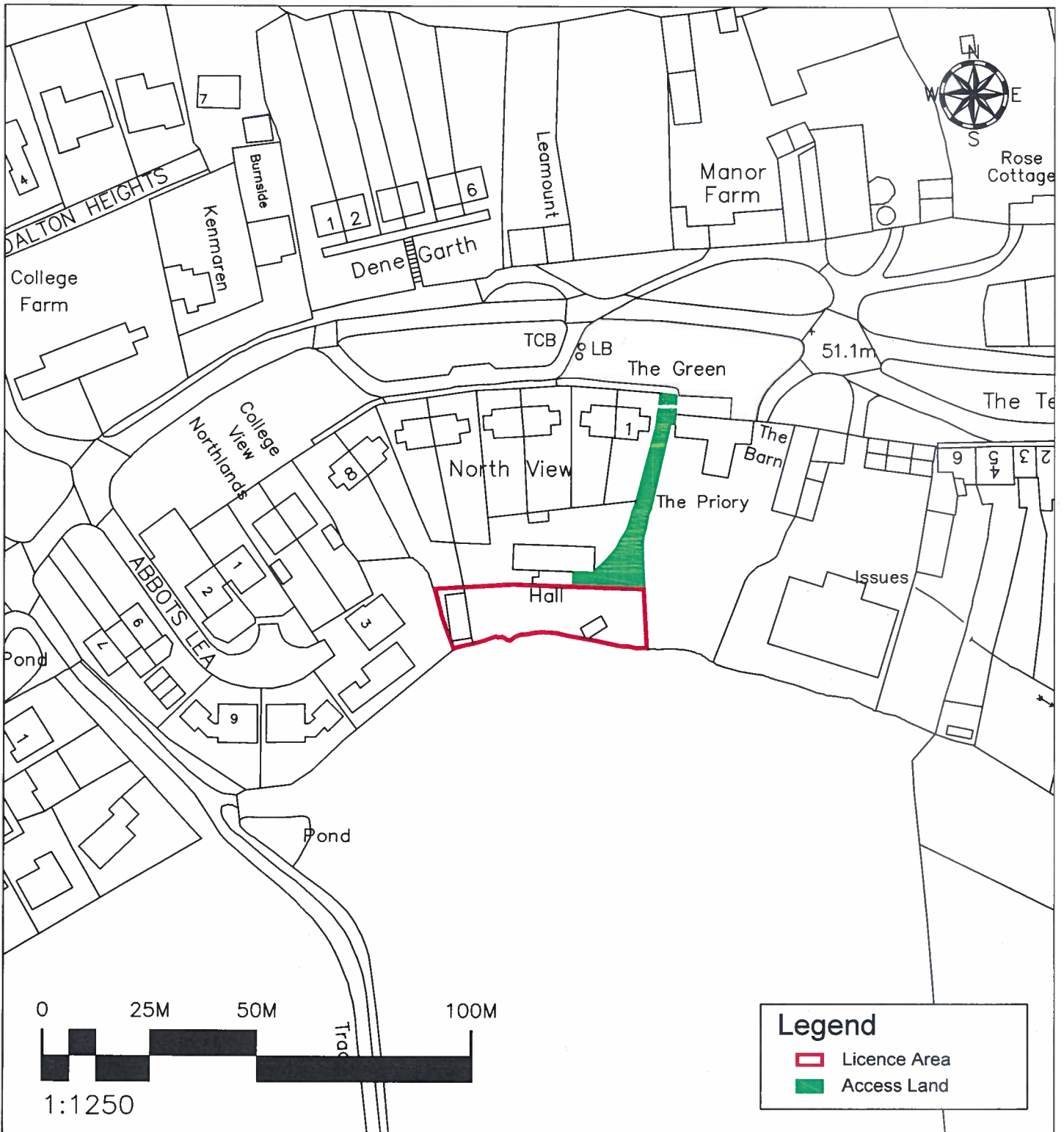

LOCATION	Land at Dalton Piercy, Hartlepool	DRAWN BY	CT	DATE	15/06/18
	AREA - 632.36 sq/m	SCALE	1:1250		
DEED PACKET	CE165605	OS MAP	NZ 4631		
		DRWG NO	E/L/511		



HARTLEPOOL BOROUGH COUNCIL
Regeneration & Neighbourhoods

Civic Centre
Victoria Road
Hartlepool
TS24 8AY

TEL: 01429 266522
FAX: 01429 523488

This map is reproduced from Ordnance Survey material with the permission of Ordnance Survey on behalf of the Controller of Her Majesty's Office © Crown copyright. Unauthorised reproduction infringes Crown copyright and may lead to prosecution or civil proceedings. Hartlepool B.C. LA09057L 1999.

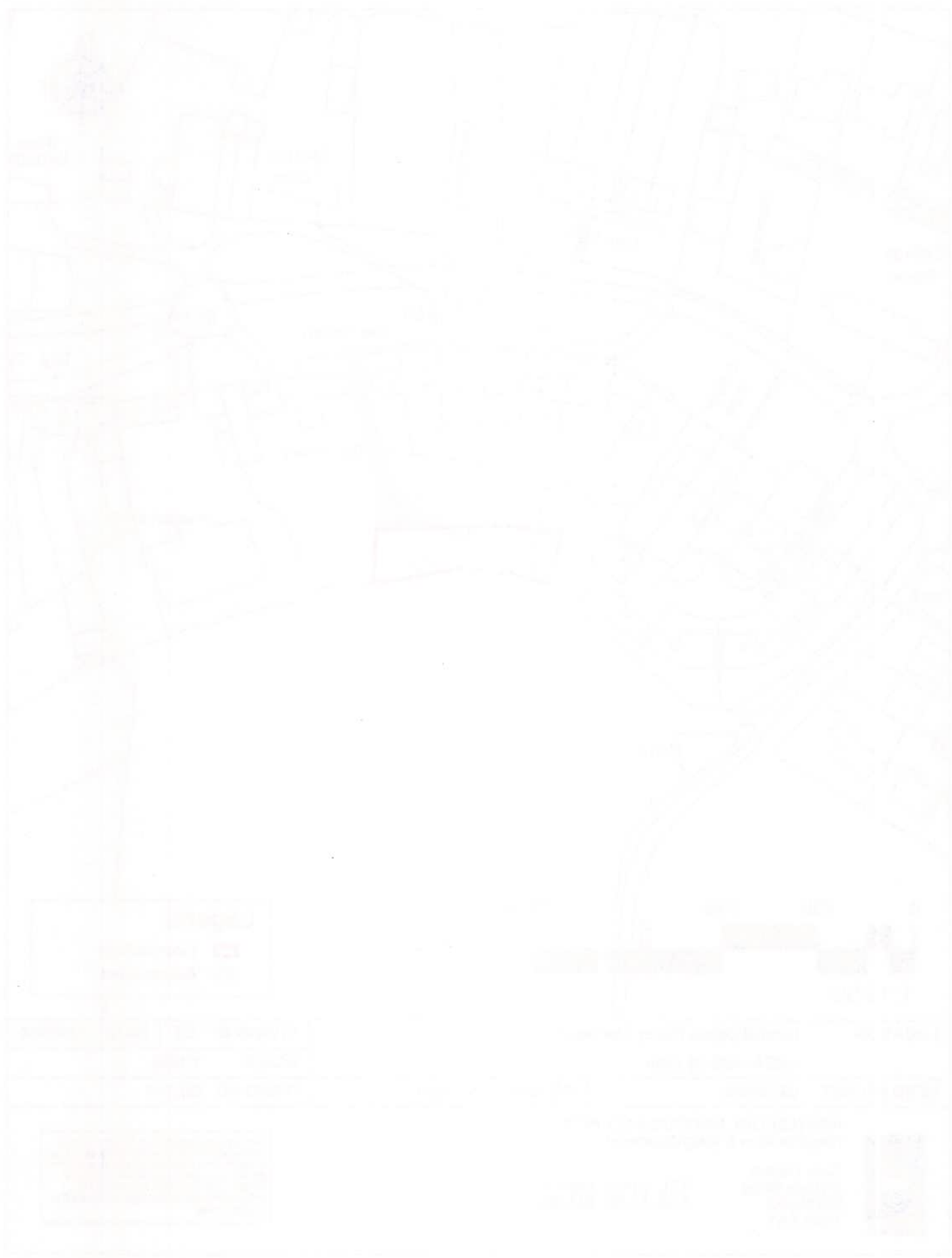

DSC