



HARTLEPOOL
BOROUGH COUNCIL
OFFICER DECISION RECORD

Department: Development, N/hoods and Regulatory Servs

Division:

Date of Decision / Issue
of Licence: 21/08/2024

Officer Making Decision: MR T HANSON

Subject / Description &
Reason for Decision: Lease Renewal of Ward Jackson Park Café

(for publication)

This property is let out, though a small part of it is retained for use by the park's groundskeepers. The current occupier's lease is due to expire in November 2024. Under the provisions of the Landlord and Tenant Act 1954 the tenant has an automatic right of renewal. Therefore, the Council approached them to offer terms for a new lease.

Type of Decision: Non Key

Nature of Delegation
Being Exercised: Delegated Authority - EDDNRS223

Alternative Options
Considered & Rejected: Not to grant the lease

Any Declared Register of
Interest: No

OFFICER WITH THE DELEGATION

NAME: MR T HANSON

POSITION: Executive Director Dev N/hood & Reg Serv

IN CONSULTATION WITH...

NAME: TONY HANSON

POSITION: Executive Director Dev N/hood & Reg Serv

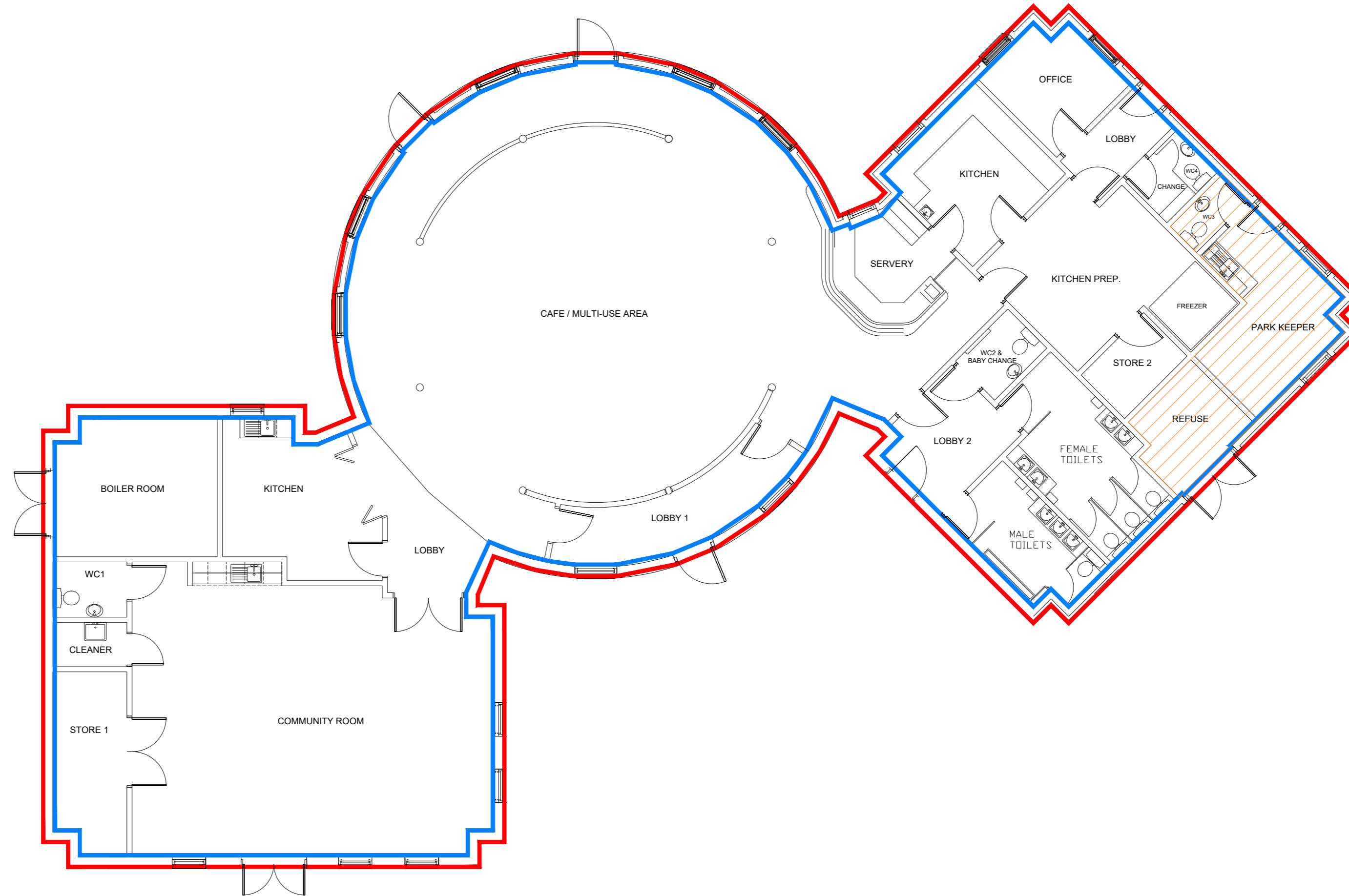

Place in the Park, Ward Jackson Park

GEA - 447.76 sq/m

GIA - 410.36 sq/m

HBC's Occupation - 22.30 sq/m

LOCATION Place in the Park, Ward Jackson Park, Hartlepool

DRAWN BY CT DATE 04/01/24

DEED PACKET CE163970

OS MAP NZ 4932 SW

SCALE NTS

DRWG NO E/F/361a



HARTLEPOOL BOROUGH COUNCIL
REGENERATION & NEIGHBOURHOODS

Civic Centre
Victoria Road
Hartlepool
TS24 8AY
Tel: 01429 266522
Fax: 01429 523899

This map is reproduced from Ordnance Survey material with the permission of Ordnance Survey on behalf of the Controller of Her Majesty's Office © Crown copyright. Unauthorised reproduction infringes Crown copyright and may lead to prosecution or civil proceedings. Hartlepool B.C. LA09057L 1999.

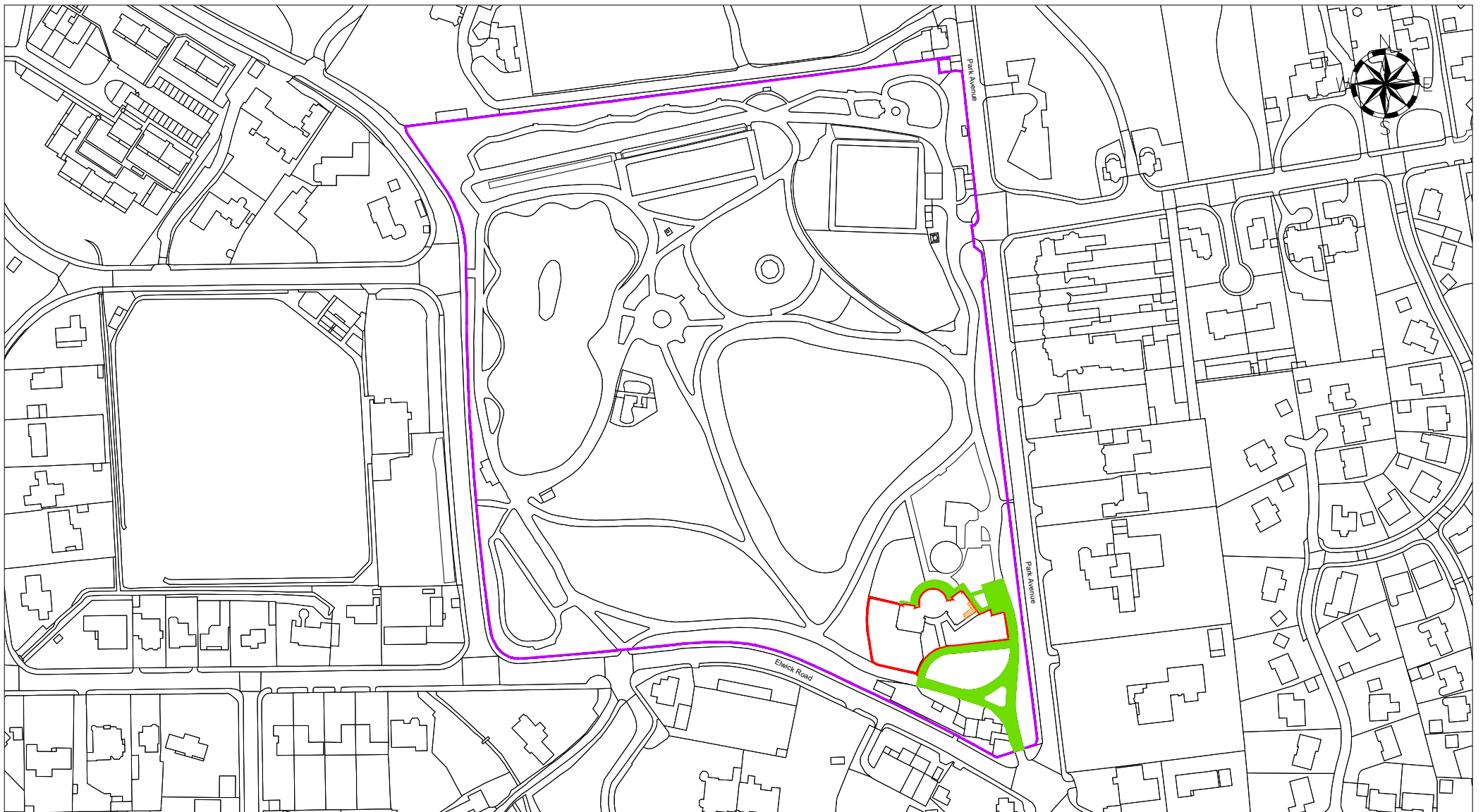

LOCATION Place in the Park, Ward Jackson Park, Hartlepool

DRAWN BY CT DATE 04/01/24

SCALE 1:1250 @ A4

DEED PACKET CE169370

OS MAP NZ 4932SW

DRWG NO E/L/232a



HARTLEPOOL BOROUGH COUNCIL
REGENERATION & NEIGHBOURHOODS

Civic Centre
Victoria Road
Hartlepool
TS24 8AY

Tel: 01429 266522
Fax: 01429 523899

This map is reproduced from Ordnance Survey material with the permission of Ordnance Survey on behalf of the Controller of Her Majesty's Office ©Crown copyright. Unauthorised reproduction infringes Crown copyright and may lead to prosecution or civil proceedings. Hartlepool B.C. LA09057L 1999.