



**HARTLEPOOL**  
**BOROUGH COUNCIL**

## OFFICER DECISION RECORD

Department:	Development, N/hoods and Regulatory Servs
Division:	
Date of Decision / Issue of Licence:	06/11/2024
Officer Making Decision:	MR T HANSON
Subject / Description & Reason for Decision: (for publication)	Grant of Licence of field at Nineacres. The Council is currently marketing agricultural land at Nineacres for sale for development purposes. The land has not been cultivated for about 7 years and is therefore fairly overgrown and boundaries are in relatively poor condition. Whilst the land is being marketed for sale, any sale will be subject to planning consent and is unlikely to complete in less than 12 months. It is therefore proposed to grant a licence for agricultural purposes for 12 months.
Type of Decision:	Non Key
Nature of Delegation Being Exercised:	EDDNRS223 Power to approve land and property disposal, leases, lettings, licences, wayleaves, easements, undertaking and concluding rent reviews, lease renewals and the release and amendments of restrictions, covenants and other land and property matters within prescribed thresholds as set out in the Finance and Policy committee arrangements
Alternative Options Considered & Rejected:	To leave the land vacant
Any Declared Register of Interest:	No

### OFFICER WITH THE DELEGATION

**NAME:** MR T HANSON

**POSITION:** Executive Director Dev N/hood & Reg Serv

### IN CONSULTATION WITH...

**NAME:** TONY HANSON

**POSITION:** Executive Director Dev N/hood & Reg Serv

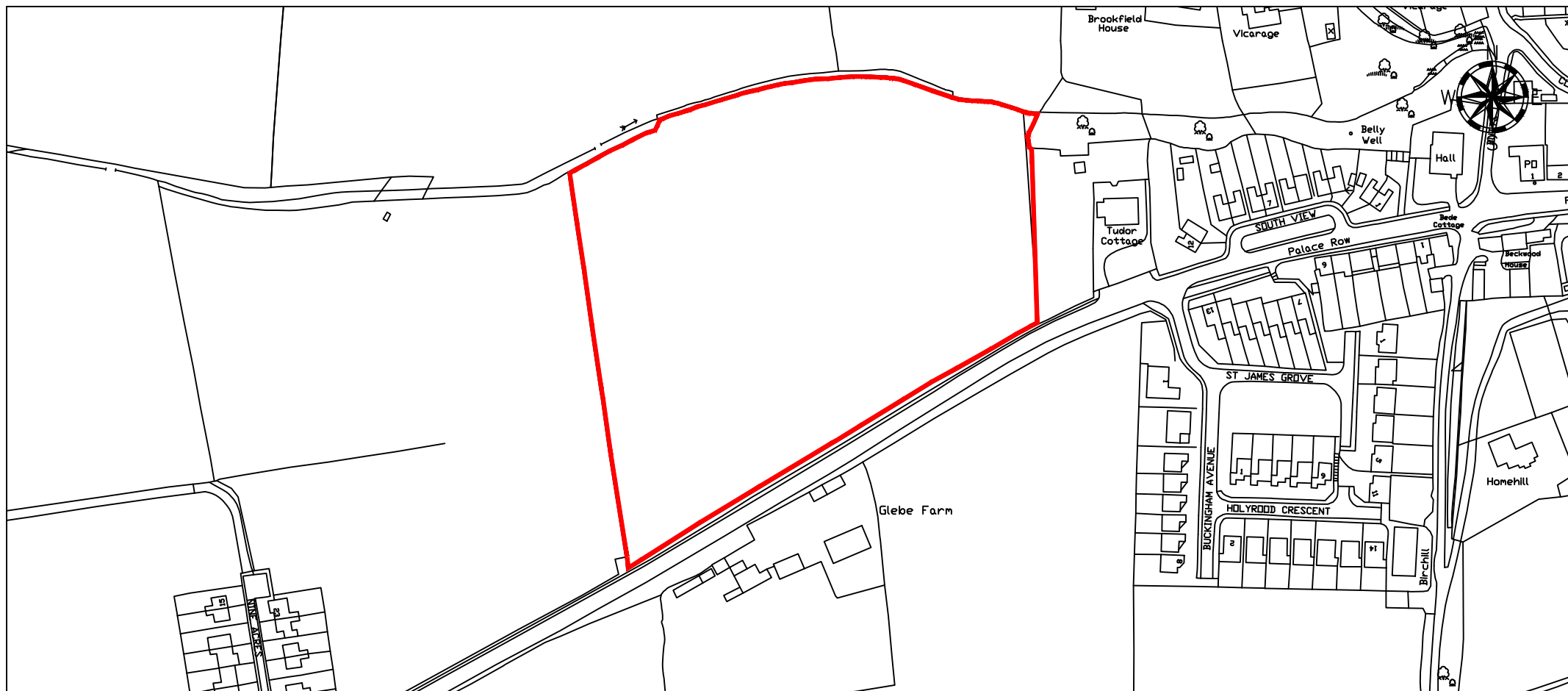

LOCATION	Land at Hart Village, Hartlepool  Area - 7.81 Acres	DRAWN BY CT		DATE	13/12/16
		SCALE		1:2500	
DEED PACKET	P172193	OS MAP	NZ4634	DRWG NO	E/L/473



**HARTLEPOOL BOROUGH COUNCIL**  
Regeneration & Neighbourhoods

Civic Centre  
Victoria Road  
Hartlepool  
TS24 8AY

TEL: 01429 266522  
FAX: 01429 523488

This map is reproduced from Ordnance Survey material with the permission of Ordnance Survey on behalf of the Controller of Her Majesty's Office ©Crown copyright. Unauthorised reproduction infringes Crown copyright and may lead to prosecution or civil proceedings. Hartlepool B.C. LA09057L 1999.