



# HARTLEPOOL BOROUGH COUNCIL

## OFFICER DECISION RECORD

Department:	Development, N/hoods and Regulatory Servs
Division:	
Date of Decision / Issue of Licence:	03/04/2025
Officer Making Decision:	MR T HANSON
Subject / Description & Reason for Decision: (for publication)	<p>Renewal of Lease of Groundbed and Cable located on the East Side of Tees Road to Norpipe Oil AS.</p> <p>Norpipe Oil AS (Company number OE032300) hold a lease from the Council of a groundbed and cathodic protection cable linked to a pumping station and laid underground in part of Seaton Common (the surface of which is leased out on a farm business tenancy). The lease runs for a term of 10 years from 5th June 2015 and is thus due for renewal in June this year. The cable forms part of the infrastructure required to bring oil and gas onshore from rigs in the North Sea.</p> <p>Terms have now been agreed for the renewal of the lease. These are considered to represent best value for the Council. The position of the cable is shown in the attached plan. The agreed terms are set out in the CONFIDENTIAL ANNEX.</p>
Type of Decision:	Non Key
Nature of Delegation Being Exercised:	EDDNRS223 Power to approve land and property disposal, leases, lettings, licences, wayleaves, easements, undertaking and concluding rent reviews, lease renewals and the release and amendments of restrictions, covenants and other land and property matters within prescribed thresholds as set out in the Finance and Policy committee arrangements
Alternative Options Considered & Rejected:	None
Any Declared Register of Interest:	No

### OFFICER WITH THE DELEGATION

**NAME:** MR T HANSON

**POSITION:** Executive Director Dev N/hood & Reg Serv

**IN CONSULTATION WITH...**

**NAME:** TONY HANSON

**POSITION:** Executive Director Dev N/hood & Reg Serv

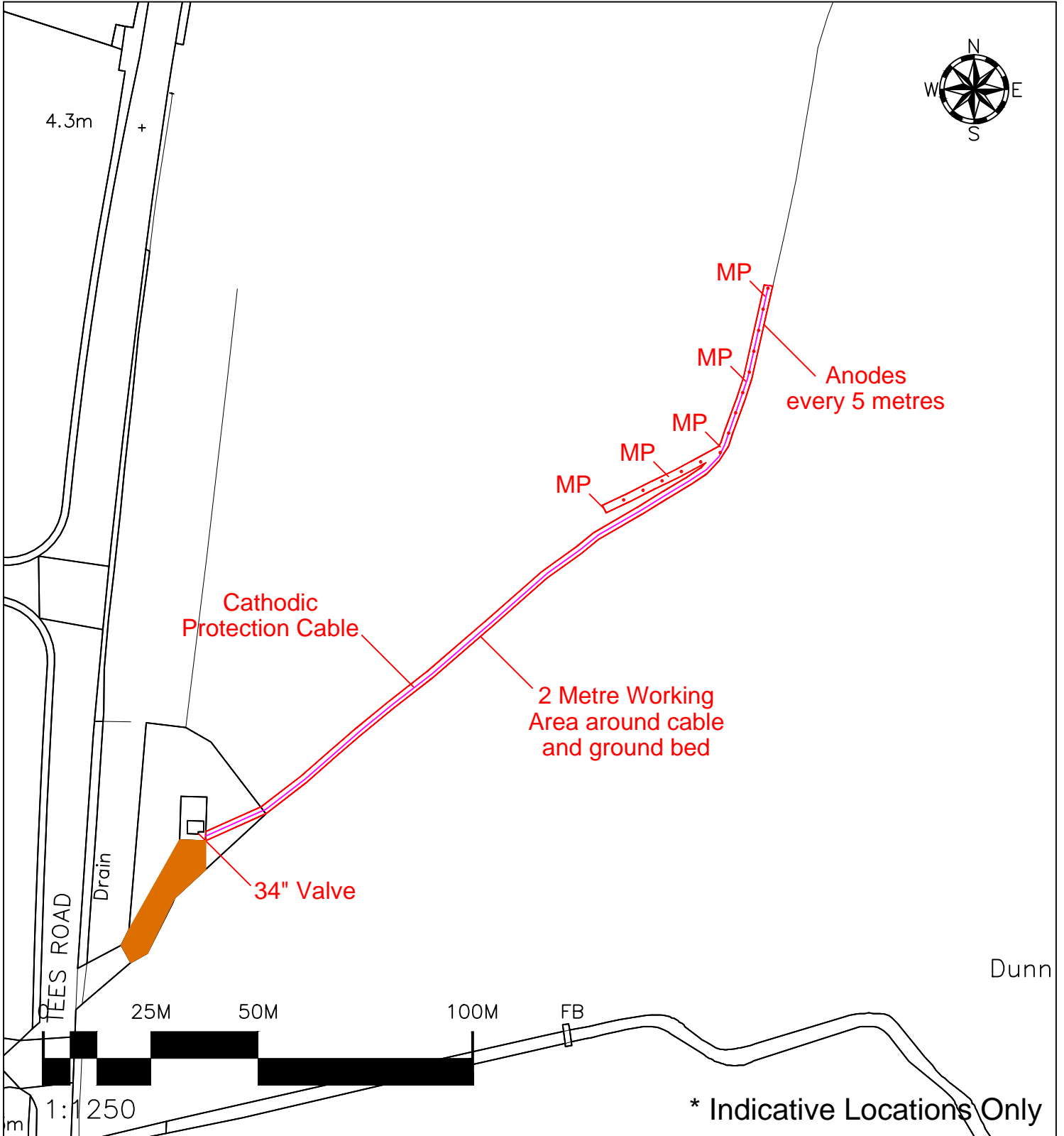

LOCATION	Cathodic Protection Installation at Tees Road, Hartlepool	DRAWN BY	CT	DATE	11/10/16
		SCALE	1:1250		
DEED PACKET	CE170910	OS MAP	-		
		DRWG NO	E/L/465		



**HARTLEPOOL BOROUGH COUNCIL**  
Regeneration & Neighbourhoods

Civic Centre  
Victoria Road  
Hartlepool  
TS24 8AY

TEL: 01429 266522  
FAX: 01429 523488

This map is reproduced from Ordnance Survey material with the permission of Ordnance Survey on behalf of the Controller of Her Majesty's Office ©Crown copyright. Unauthorised reproduction infringes Crown copyright and may lead to prosecution or civil proceedings. Hartlepool B.C. LA09057L 1999.